

## PCB Supports - Standard Double Barb Types

### PAD Series

Suitable for small PCB's

Part Number	Spacing A 1.5mm PCB	Mounting Holes Panel & PCB 3.5mm
05-PAD06	6.3	<b>Panel Thickness</b> 0.8 – 2.0mm
05-PAD08	8.0	
05-PAD10	9.6	
05-PAD12	12.7	

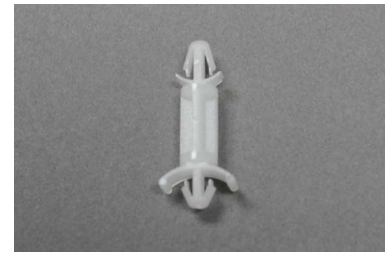
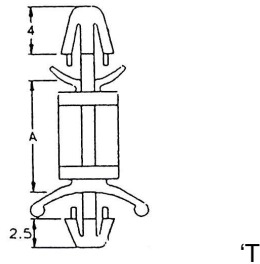

### PBA Series

Quick assembly of standard size PCB's  
Tension hold option for easy removal of PCB

Part Number PBAxxL	Part Number PBAxxT	Spacing B 1.5mm PCB	Mounting Holes PCB 4.0mm Panel 4.8mm
05-PBA05L	05-PBA05T	7.8	<b>Panel Thickness</b> 0.8 – 2.0mm
05-PBA06L	05-PBA06T	9.2	
05-PBA13L	05-PBA13T	15.9	
05-PBA16L	05-PBA16T	18.9	
05-PBA19L	05-PBA19T	22.1	
05-PBA25L	05-PBA25T	28.4	
		<b>Material: Nylon 6/6</b>	

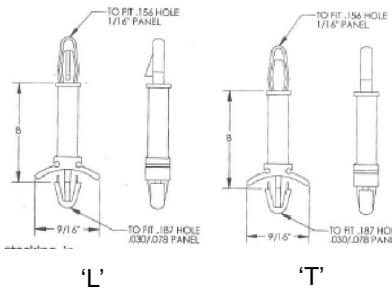

### PBB Series

Firm spring grip of PCB

Part Number	Spacing A 1.5mm PCB	Mounting Holes PCB 4.0mm Panel 4.8mm
05-PBB05	6.3	<b>Panel Thickness</b> 0.8 – 2.0mm
05-PBB06	7.9	
05-PBB10	11.1	
05-PBB13	14.2	
05-PBB16	17.4	
05-PBB19	20.6	
05-PBB22	22.2	
05-PBB25	26.0	
05-PBB28	28.0	

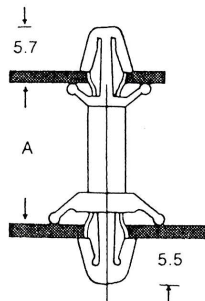

### LCBS Series

Part Number	Spacing A
05-LCBS-35	35.0

### PBC Series

Part Number	Spacing A
05-PBC05L	6.4

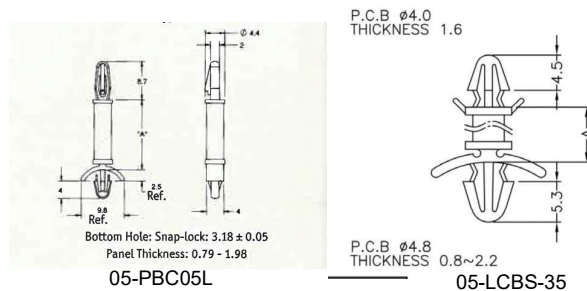

## PCB Support – Dual Locking

### PAG Series

Clips at each end lock into panel thicknesses of 1.2-1.7

Part Number	Spacing A	Mounting Holes 3.5mm Both ends
05-PAG15	15.0	<b>Material: Nylon 6/6</b>

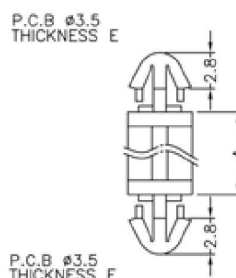

## PCB Support – Adhesive Mount

No panel holes required

### PSB Series

PCB Hole 4.0mm

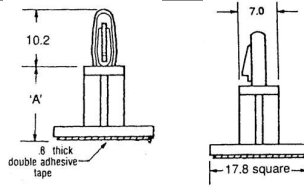

### PSA Series

PCB Hole 3.0mm

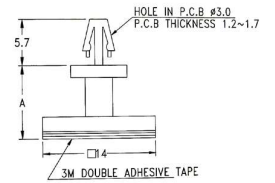

Part Number	Spacing A
05-PSB06	6.3
05-PSB10	9.5
05-PSB13	12.7
05-PSB16	15.9
05-PSB19	19.1
05-PSB25	25.4
05-PSB30	28.6

Part Number	Spacing A
05-PSA06	6.3
05-PSA09	9.0
05-PSA13	12.7

## PCB Screw Support – Adhesive Mount

Low profile mount with #4 self tap screw

### PASR Series

Part Number	Spacing A
05-PASR06	6.4
05-PASR11	10.8

Material: Nylon 6/6

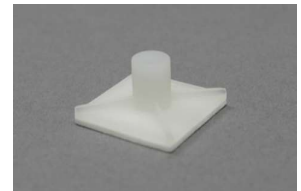
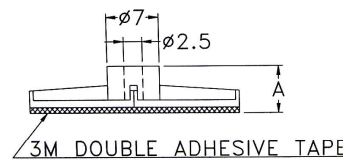
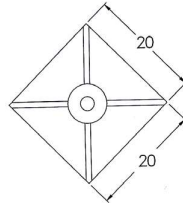

## PCB Edge Support – Adhesive Mount

For mounting without holes in PCB or panel

• Spacer edge hold

### PUB Series

Part Number	A	B	C
05-PUB06	11.3	2.6	6.0
05-PUB08	12.8	2.4	7.9

Material: Nylon 6/6

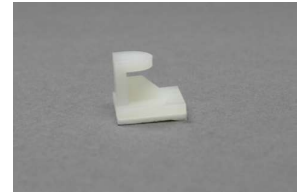
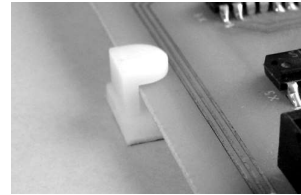
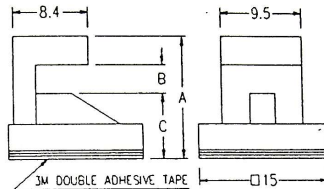

## Blind Hole Mount

Flexible ribs lock into blind hole (e.g. wood panels)

Quick release locking clip

Part Number	Spacing A
05-PTB05	5.2
05-PTB09	9.5

Material: Nylon 6/6

### Mounting Holes

PCB 4.0mm  
Panel 8.0mm

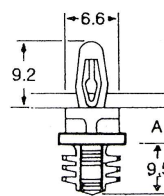

## Dual Locking

Clips at each end which lock into panel thicknesses of 0.5-2.0mm

### PBM Series

Part Number	Spacing A
05-PBM06	9.27
05-PBM08	10.72
05-PBM10	9.5
05-PBM13	12.7
05-PBM16	18.92
05-PBM32	34.8

Material: Nylon 6/6

### Mounting Holes

4.8mm  
Both ends

