

PCB Posts - Double End Types

Ideal for small printed circuit boards or mounting on motherboards
Uses same size holes at each end

PML Series

| Part Number | Spacing A 1.5mm PCB |
|-------------|---------------------|
| 05-PML08L | 8 |

Material: Nylon 6/6

PML Mounting Holes
PCB 4mm
Panel 3mm

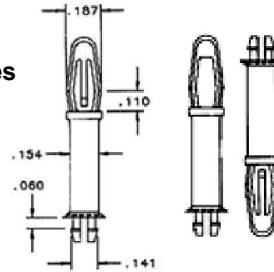

MAF Series

| Part Number | Spacing A |
|-------------|-----------|
| 05-MAF10 | 10 |

Material: Nylon 6/6

P.C.B Ø4.0
THICKNESS 1.6

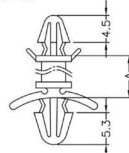

P.C.B Ø4.8
THICKNESS 0.8~2.2

PCB Spacer Support

PDC Series

| Part Number | Spacing A | PDC Series Mounting Holes 3.5mm Dia. |
|-------------|-----------|--------------------------------------|
| 05-PDC030 | 3.0 | |
| 05-PDC040 | 4.0 | |
| 05-PDC045 | 4.5 | |
| 05-PDC050 | 5.0 | |
| 05-PDC055 | 5.5 | |
| 05-PDC060 | 6.0 | |

Material: Nylon 6/6

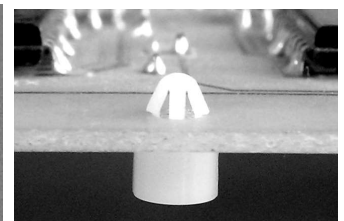
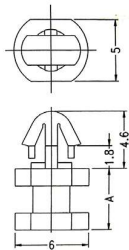

DCB Series

| Part Number | Spacing A | C | DCB Series Mounting Holes 3.0mm Dia. |
|-------------|-----------|-----|--------------------------------------|
| 05-DCB-9D | 9.0 | 4.0 | |

Material: Nylon 6/6

P.C.B Ø3.0
THICKNESS: B

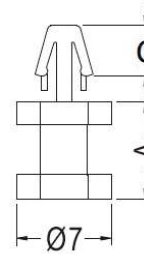

DCC Series

| Part Number | Spacing A | DCC Series Mounting Holes 3.0mm Dia. |
|-------------|-----------|--------------------------------------|
| 05-DCC-3.5 | 3.5 | |

Material: Nylon 6/6

P.C.B Ø3.0
THICKNESS E

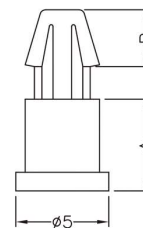

KMC Series

| Part Number | Spacing A | KMC Series Mounting Holes 4.0mm Dia. |
|-------------|-----------|--------------------------------------|
| 05-KMC05 | 5.0 | |

Material: Nylon 6/6

P.C.B Ø4.0
THICKNESS B

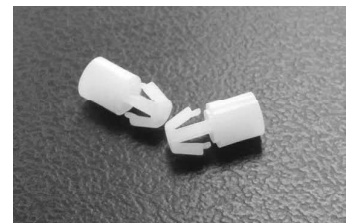
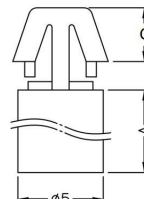

PCB Posts - Double End Types

Ideal for small printed circuit boards or mounting on motherboards • Patented design for extra stability

Locking Clip End and Tension Grip End

| Part Number | Spacing A 1.5mm PCB | PMS Mounting Holes 4.0mm Dia. Both ends |
|-------------|---------------------|--|
| 05-PMS03 | 3.2 | Material: Nylon 6/6 |
| 05-PMS04 | 4 | |
| 05-PMS06 | 6.3 | |
| 05-PMS08 | 8.0 | |
| 05-PMS10 | 9.5 | |
| 05-PMS11 | 11.1 | |
| 05-PMS12 | 12 | |
| 05-PMS13 | 12.7 | |
| 05-PMS16 | 15.9 | |
| 05-PMS19 | 19.1 | |
| 05-PMS25 | 25.4 | |
| 05-PMS45 | 45.7 | |

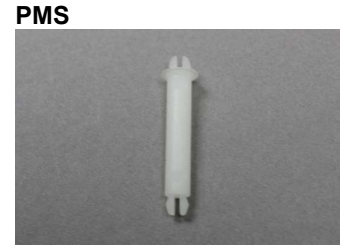
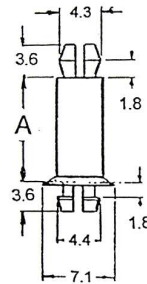

| Spacing A 1.5mm PCB | Part Number 2.0mm Dia Mounting Holes Both Ends | Part Number 2.5mm Dia. Mounting Holes Both Ends |
|---------------------|--|---|
| 3.0 | 05-PMD03 | 05-PMG03 |
| 4.0 | 05-PMD04 | 05-PMG04 |
| 5.0 | 05-PMD05 | 05-PMG05 |
| 6.3 | 05-PMD06 | 05-PMG06 |
| 6.5 | 05-PMD6.5 | - |
| 8.0 | 05-PMD08 | 05-PMG08 |
| 10.5 | 05-PMD10 | 05-PMG10 |
| 10.00 | - | 05-PMG10A |
| 12.7 | - | 05-PMG13 |
| 14 | 05-PMD14 | - |
| 22 | 05-PMD022 | - |

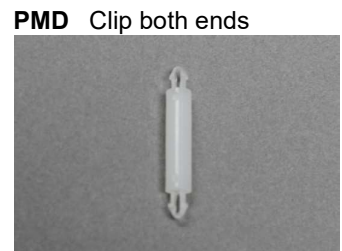
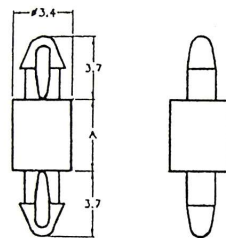

| Spacing A 1.5mm PCB | Part Number 3.2mm Dia Mounting Holes Both Ends | Part Number 4.0mm Dia. Mounting Holes Both Ends |
|---------------------|--|---|
| 3.2 | 05-PMM03 | 05-PMP03 |
| 6.3 | 05-PMM06 | 05-PMP06 |
| 8.0 | 05-PMM08 | 05-PMP08 |
| 9.5 | 05-PMM10 | 05-PMP10 |
| 11.1 | 05-PMM11 | 05-PMP11 |
| 12.7 | 05-PMM13 | 05-PMP13 |
| 15.9 | 05-PMM16 | 05-PMP16 |
| 19.1 | 05-PMM19 | 05-PMP19 |
| 22.2 | - | 05-PMP22 |
| 25.4 | 05-PMM25 | 05-PMP25 |

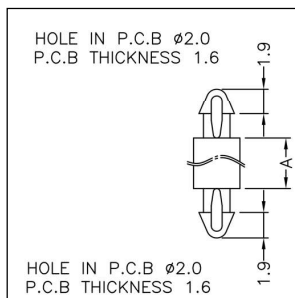
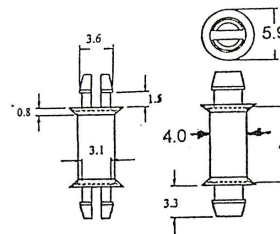
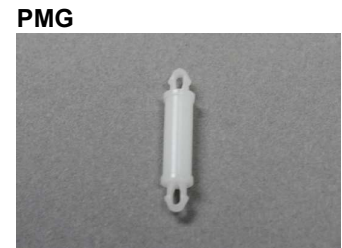
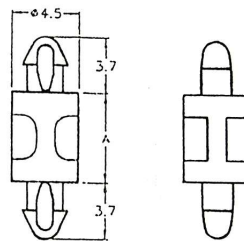

Please note this picture relates to 05-PMD14 only

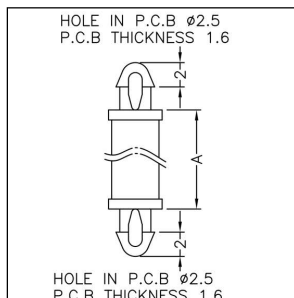

Please note this picture relates to 05-PMG13 only

